



U.S. Department of Energy Categorical Exclusion Determination Form

Submit by E-mail

Proposed Action Title: Erosion repair work at Structure 53/1 on the Liberty Parker No. 2 Transmission Line

Program or Field Office: Western Area Power Administration/ Desert Southwest Region

Location(s) (City/County/State): La Paz County, Arizona

Proposed Action Description:

Western proposes to conduct erosion repair work at existing Structure 53-1 on the Liberty-Parker Dam #2 230-kV Transmission Line and conduct repairs to existing access roads in order to access the transmission line right-of-way (ROW). The project is located west of Aguila and north of US 60, on lands administered by the US Bureau of Land Management (BLM) Lake Havasu Field Office in La Paz County, Arizona.

The structure foundation is exposed, because water flowing in an ephemeral wash eroded ground surface approximately 3 feet below the original level.

SEE CONTINUATION SHEET

Categorical Exclusion(s) Applied:

B4.6 - Additions and modifications to transmission facilities

For the complete DOE National Environmental Policy Act regulations regarding categorical exclusions, including the full text of each categorical exclusion, see Subpart D of 10 CFR Part 1021.

Regulatory Requirements in 10 CFR 1021.410(b): (See full text in regulation)

The proposal fits within a class of actions that is listed in Appendix A or B to 10 CFR Part 1021, Subpart D.

To fit within the classes of actions listed in 10 CFR Part 1021, Subpart D, Appendix B, a proposal must be one that would not: (1) threaten a violation of applicable statutory, regulatory, or permit requirements for environment, safety, and health, or similar requirements of DOE or Executive Orders; (2) require siting and construction or major expansion of waste storage, disposal, recovery, or treatment facilities (including incinerators), but the proposal may include categorically excluded waste storage, disposal, recovery, or treatment actions or facilities; (3) disturb hazardous substances, pollutants, contaminants, or CERCLA-excluded petroleum and natural gas products that preexist in the environment such that there would be uncontrolled or unpermitted releases; (4) have the potential to cause significant impacts on environmentally sensitive resources, including, but not limited to, those listed in paragraph B(4) of 10 CFR Part 1021, Subpart D, Appendix B; (5) involve genetically engineered organisms, synthetic biology, governmentally designated noxious weeds, or invasive species, unless the proposed activity would be contained or confined in a manner designed and operated to prevent unauthorized release into the environment and conducted in accordance with applicable requirements, such as those listed in paragraph B(5) of 10 CFR Part 1021, Subpart D, Appendix B.

There are no extraordinary circumstances related to the proposal that may affect the significance of the environmental effects of the proposal.

The proposal has not been segmented to meet the definition of a categorical exclusion. This proposal is not connected to other actions with potentially significant impacts (40 CFR 1508.25(a)(1)), is not related to other actions with individually insignificant but cumulatively significant impacts (40 CFR 1508.27(b)(7)), and is not precluded by 40 CFR 1506.1 or 10 CFR 1021.211 concerning limitations on actions during preparation of an environmental impact statement.

Based on my review of the proposed action, as NEPA Compliance Officer (as authorized under DOE Order 451.1B), I have determined that the proposed action fits within the specified class(es) of action, the other regulatory requirements set forth above are met, and the proposed action is hereby categorically excluded from further NEPA review.

NEPA Compliance Officer: *Mariah...*
Acting For Linda Marichito

Date Determined: 6/9/14

**CONTINUATION SHEET for
Erosion repair work at Structure 53/1 on the Liberty Parker No. 2 Transmission Line**

Project Description Continued

The scope of work includes the following:

- 1. Erosion repair at Liberty Parker Structure 53-1**
 - a) Excavate for riprap installation and re-route channel in location of revetments to allow adequate flows.
 - b) Provide stone riprap revetments around the structure.
 - c) Clear brush and trees as necessary to install riprap.
 - d) Establish a low water crossing between the proposed staging area (below) and the structures to allow passage of construction and maintenance vehicles across the wash during low flow/no flow conditions.
 - e) Restore temporary construction areas to natural contour at project completion.
- 2. Temporary Construction Area (approximately 0.9 acre)**
 - a) Establish a temporary staging area outside the existing ROW and adjacent to an existing dirt road below the Centennial Wash earthen berm.
 - b) Grade the staging areas as necessary for construction utilization.
 - c) Restore area to original contours and restore the staging area after project completion.
 - d) Install a gate in the existing fence to provide access to the ROW for construction and maintenance traffic.
- 3. Access Road Repair (approximately 2.4 miles)**
 - a) Repair water damage and potholes along Urea Ranch Road and an unnamed dirt road from the intersection with US 60 to the Western ROW. The road repairs will be conducted to allow for the safe passage of construction and maintenance vehicles from US 60 to the Western ROW.
 - b) Blade or grade existing road surfaces (approximately 12 feet in width) as needed.
 - c) Preserve cattle guards, railroad crossings, and other existing features.
 - d) For approximately 5,000 feet along the east-west segment of the unnamed dirt road, install low water/no flow crossings where the roadway has become eroded or damaged due to wash flows.

Equipment used on-site may include dozers, front end loaders, and dump trucks. Transport trucks with flatbed trailers may be necessary for delivery of some materials. Specialized equipment, such as hydraulic hammers and backhoes, may be used for driving steel angles or sheet piling. All work would be completed in the dry season with locally sourced fill materials from a commercial company. No backfill material would be left in the wash channel upon construction completion.

Because of the urgency of the proposed project, Western plans to begin project activities no sooner than November 1, 2014. The project will be completed within four weeks.

CONTINUED

**CONTINUATION SHEET for
Erosion repair work at Structure 53/1 on the Liberty Parker No. 2 Transmission Line**

Special Conditions

1. To avoid impacts to protected migratory birds, Western will schedule project activities between August 1 and February 14, as feasible. If soil or vegetation-disturbing activities will occur between February 15 and June 30, a qualified biologist will conduct a pre-construction survey at all work areas (e.g., equipment staging areas and access roads, erosion repair areas) for native nesting birds. The biologist will flag any active nests with an appropriate buffer area, depending on the species and the nature of the work being conducted.
2. Western will ensure that the Construction contractor obtains a Storm Water Construction General Permit from the Arizona Department of Environmental Quality (ADEQ) as appropriate if the disturbed construction area equals 1 acre or more. The Contractor shall obtain a Storm Water Construction General permit and be responsible for preparation and implementation of the associated Storm Water Pollution Prevention Plan (SWPPP). Disturbed areas include staging, parking, fueling, stockpiling, and any other construction related activities. The Contractor shall submit to ADEQ a Notice of Intent Application and appropriate fees (depending on total surface area disturbed). Refer to <http://www.azdeq.gov/environ/water/permits/cgp.html> for directions and forms.
3. Western will ensure that the Construction contractor develops and implements a SWPPP that satisfies the conditions of the permit. A copy of SWPPP shall be kept at the work site.
4. Western will ensure that no work will occur within jurisdictional Waters of the United States (Waters), including dry washes, until the appropriate Clean Water Act Section 401 and 404 permits are obtained or until a Pre-construction Notification has been sent to the U.S. Corps of Engineers (Corps). If project impacts within Waters are less than 0.1 acres, the Construction contractor shall comply with all terms and conditions of the Section 404 Nationwide Permit 12 as established by the Corps. Western will provide notice to proceed to the Contractor once acreage of impacts to Waters and the need for permitting has been determined.
5. Western will ensure that cactus and agaves are left in place and undisturbed wherever possible. Small cacti and agave that cannot be avoided will be replanted outside of work areas. Prickly pear and cholla may be scattered on-site to facilitate resprouting.

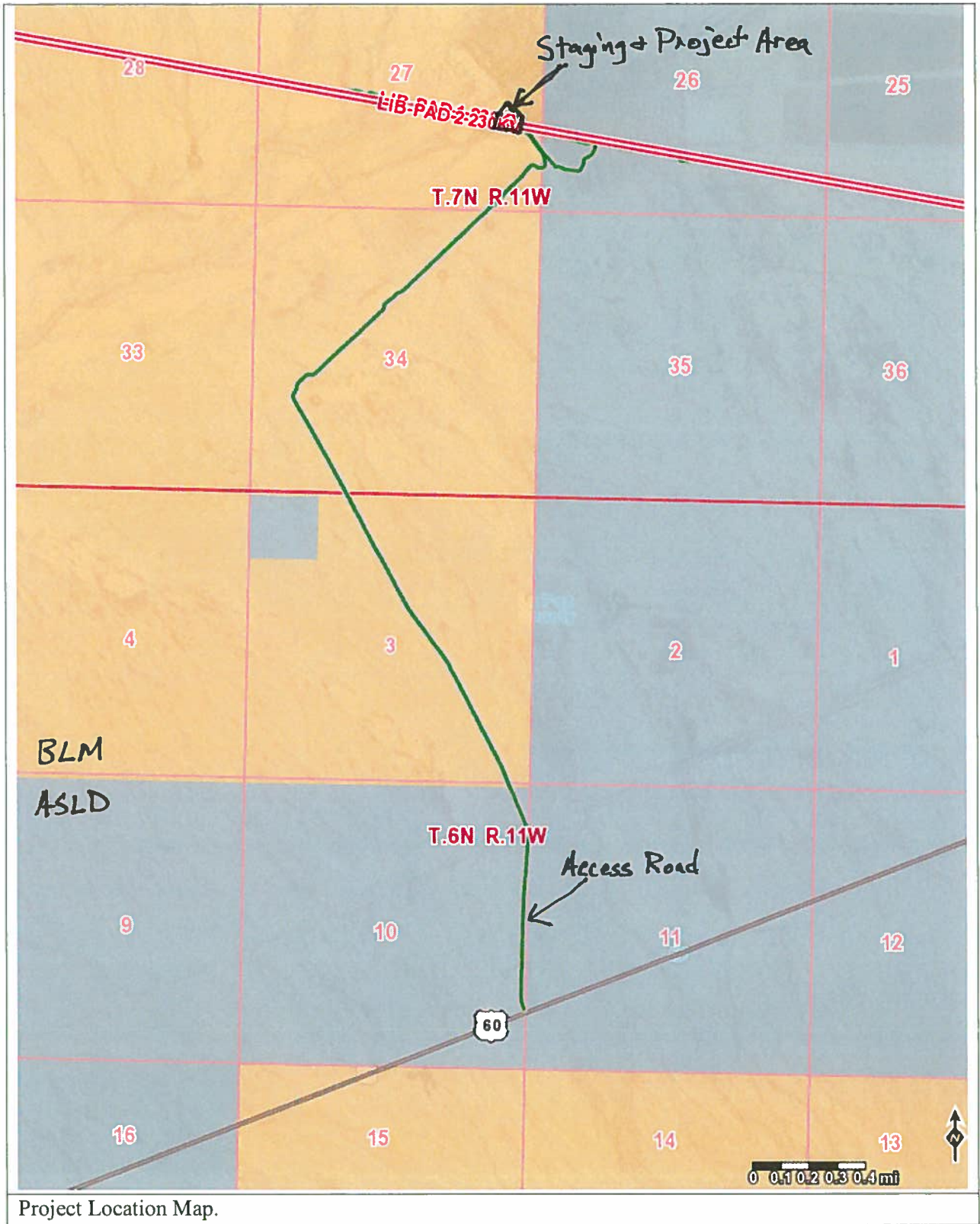

Project Location Map.

Checklist for Categorical Exclusion Determination, revised Nov. 2011

Application of Categorical Exclusions (1021.410)	Disagree	Agree	Unknown
(b)(1) The proposal fits within a class of actions that is listed in appendix A or B to subpart D.		X	
(b)(2) There are no extraordinary circumstances related to the proposal that may affect the significance of the environmental effects of the proposal, including, but not limited to, scientific controversy about the environmental effects of the proposal; uncertain effects or effects involving unique or unknown risks; and unresolved conflicts concerning alternate uses of available resources		X	
(b)(3) The proposal has not been segmented to meet the definition of a categorical exclusion. Segmentation can occur when a proposal is broken down into small parts in order to avoid the appearance of significance of the total action. The scope of a proposal must include the consideration of connected and cumulative actions, that is, the proposal is not connected to other actions with potentially significant impacts (40 CFR 1508.25(a)(1), is not related to other actions with individually insignificant but cumulatively significant impacts (40 CFR 1508.27(b)(7)), and is not precluded by 40 CFR 1506.1 or § 1021.211 of this part concerning limitations on actions during EIS preparation.		X	
B. Conditions that are Integral Elements of the Classes of Actions in Appendix B. :	NO	YES	UNKNOWN
(1) Threaten a violation of applicable statutory, regulatory, or permit requirements for environment, safety and health, or similar requirements of DOE or Executive Orders.	X		
(2) Require siting and construction or major expansion of waste storage, disposal, recovery, or treatment facilities (including incinerators), but the proposal may include categorically excluded waste storage, disposal, recovery, or treatment actions or facilities;	X		
(3) Disturb hazardous substances, pollutants, contaminants, or CERCLA-excluded petroleum and natural gas products that preexist in the environment such that there would be uncontrolled or unpermitted releases;	X		
(4) Have the potential to cause significant impacts on environmentally sensitive resources. An environmentally sensitive resource is typically a resource that has been identified as needing protection through Executive Order, statute, or regulation by Federal, state, or local government, or a federally recognized Indian tribe. An action may be categorically excluded if, although sensitive resources are present, the action would not have the potential to cause significant impacts on those resources (such as construction of a building with its foundation well above a sole-source aquifer or upland surface soil removal on a site that has wetlands). Environmentally sensitive resources include, but are not limited to:	X		

(i)	Property (such as sites, buildings, structures, and objects) of historic, archaeological, or architectural significance designated by a Federal, state, or local government, or property determined to be eligible for listing on the National Register of Historic Places;	X		
(ii)	Federally-listed threatened or endangered species or their habitat (including critical habitat) or Federally- proposed or candidate species or their habitat (Endangered Species Act); state-listed or state-proposed endangered or threatened species or their habitat; Federally-protected marine mammals and Essential Fish Habitat (Marine Mammal Protection Act; Magnuson-Stevens Fishery Conservation and Management Act); and otherwise Federally-protected species (such as under the Bald and Golden Eagle Protection Act or the Migratory Bird Treaty Act);	X		
(iii)	Floodplains and wetlands (as defined in 10 CFR 1022.4, —Compliance with Floodplain and Wetland Environmental Review Requirements: “Definitions,” or its successor);	X		
(iv)	Areas having a special designation such as Federally- and state-designated wilderness areas, national parks, national monuments, national natural landmarks, wild and scenic rivers, state and Federal wildlife refuges, scenic areas (such as National Scenic and Historic Trails or National Scenic Areas), and marine sanctuaries;	X		
(v)	Prime or unique farmland, or other farmland of statewide or local importance, as defined at 7 CFR 658.2(a), —Farmland Protection Policy Act: Definitions, or its successor;	X		
(vi)	Special sources of water (such as sole-source aquifers, wellhead protection areas, and other water sources that are vital in a region); and	X		
(vii)	Tundra, coral reefs, or rain forests.; or	X		
(5)	Involve genetically engineered organisms, synthetic biology, governmentally designated noxious weeds, or invasive species, unless the proposed activity would be contained or confined in a manner designed and operated to prevent unauthorized release into the environment and conducted in accordance with applicable requirements, such as those of the Department of Agriculture, the Environmental Protection Agency, and the National Institutes of Health.	X		