

# U.S. Department of Energy Categorical Exclusion Determination Form

Submit by E-mail

Proposed Action Title: Outgrant to Southwest Gas for an underground natural gas distribution pipeline at Coolidge Substation

Program or Field Office: Western Area Power Administration/ Desert Southwest Region

Location(s) (City/County/State): Coolidge, Pinal County, Arizona

Proposed Action Description:

Western proposes to issue an outgrant easement to Southwest Gas Corporation for the construction, operation, and maintenance of an underground natural gas distribution pipeline that crosses Western's Coolidge Substation located at 2288 North Arizona Boulevard, Coolidge, Pinal County, Arizona. Western owns the substation property in fee. The outgrant covers approximately 0.29 acres and measures 10 feet wide by 1288 feet long (0.25 mile). It occurs within a portion of the northeast quarter of the southeast quarter of Section 9 in Township 5 South, Range 8 East on the Gila and Salt River Baseline and Meridian.

Southwest Gas applied to Western for an outgrant, because the existing pipeline, which also crosses the substation property, requires replacement based on age (it was built in 1952) and integrity studies. The line, which overall is 0.75-mile-long, serves six customers situated west of the substation.

Southwest Gas plans to abandon in-place an existing underground steel natural gas pipeline and install a new 2-inch-diameter polyethylene one. They propose to dig a 1-foot-wide, 4-to-5-foot-deep trench using a backhoe or trencher. Workers will drive construction equipment on the existing dirt road (i.e., Silverhawk/ Clark Farm Rd) and park on the shoulder. Pipe connections may be butt welded or heat fused. They plan to bore under Arizona Boulevard and any other surface obstructions. A staging area may be located on private land located west of the substation. No road or lane closures are planned. They plan to start work in February 2014, and construction is expected to occur intermittently over 30 days.

SEE CONTINUATION SHEET +

Categorical Exclusion(s) Applied:

B1.24 - Property transfers

For the complete DOE National Environmental Policy Act regulations regarding categorical exclusions, including the full text of each categorical exclusion, see Subpart D of 10 CFR Part 1021.

Regulatory Requirements in 10 CFR 1021.410(b): (See full text in regulation)

The proposal fits within a class of actions that is listed in Appendix A or B to 10 CFR Part 1021, Subpart D.

To fit within the classes of actions listed in 10 CFR Part 1021, Subpart D, Appendix B, a proposal must be one that would not: (1) threaten a violation of applicable statutory, regulatory, or permit requirements for environment, safety, and health, or similar requirements of DOE or Executive Orders; (2) require siting and construction or major expansion of waste storage, disposal, recovery, or treatment facilities (including incinerators), but the proposal may include categorically excluded waste storage, disposal, recovery, or treatment actions or facilities; (3) disturb hazardous substances, pollutants, contaminants, or CERCLA-excluded petroleum and natural gas products that preexist in the environment such that there would be uncontrolled or unpermitted releases; (4) have the potential to cause significant impacts on environmentally sensitive resources, including, but not limited to, those listed in paragraph B(4) of 10 CFR Part 1021, Subpart D, Appendix B; (5) involve genetically engineered organisms, synthetic biology, governmentally designated noxious weeds, or invasive species, unless the proposed activity would be contained or confined in a manner designed and operated to prevent unauthorized release into the environment and conducted in accordance with applicable requirements, such as those listed in paragraph B(5) of 10 CFR Part 1021, Subpart D, Appendix B.

There are no extraordinary circumstances related to the proposal that may affect the significance of the environmental effects of the proposal.

The proposal has not been segmented to meet the definition of a categorical exclusion. This proposal is not connected to other actions with potentially significant impacts (40 CFR 1508.25(a)(1)), is not related to other actions with individually insignificant but cumulatively significant impacts (40 CFR 1508.27(b)(7)), and is not precluded by 40 CFR 1506.1 or 10 CFR 1021.211 concerning limitations on actions during preparation of an environmental impact statement.

Based on my review of the proposed action, as NEPA Compliance Officer (as authorized under DOE Order 451.1B), I have determined that the proposed action fits within the specified class(es) of action, the other regulatory requirements set forth above are met, and the proposed action is hereby categorically excluded from further NEPA review.





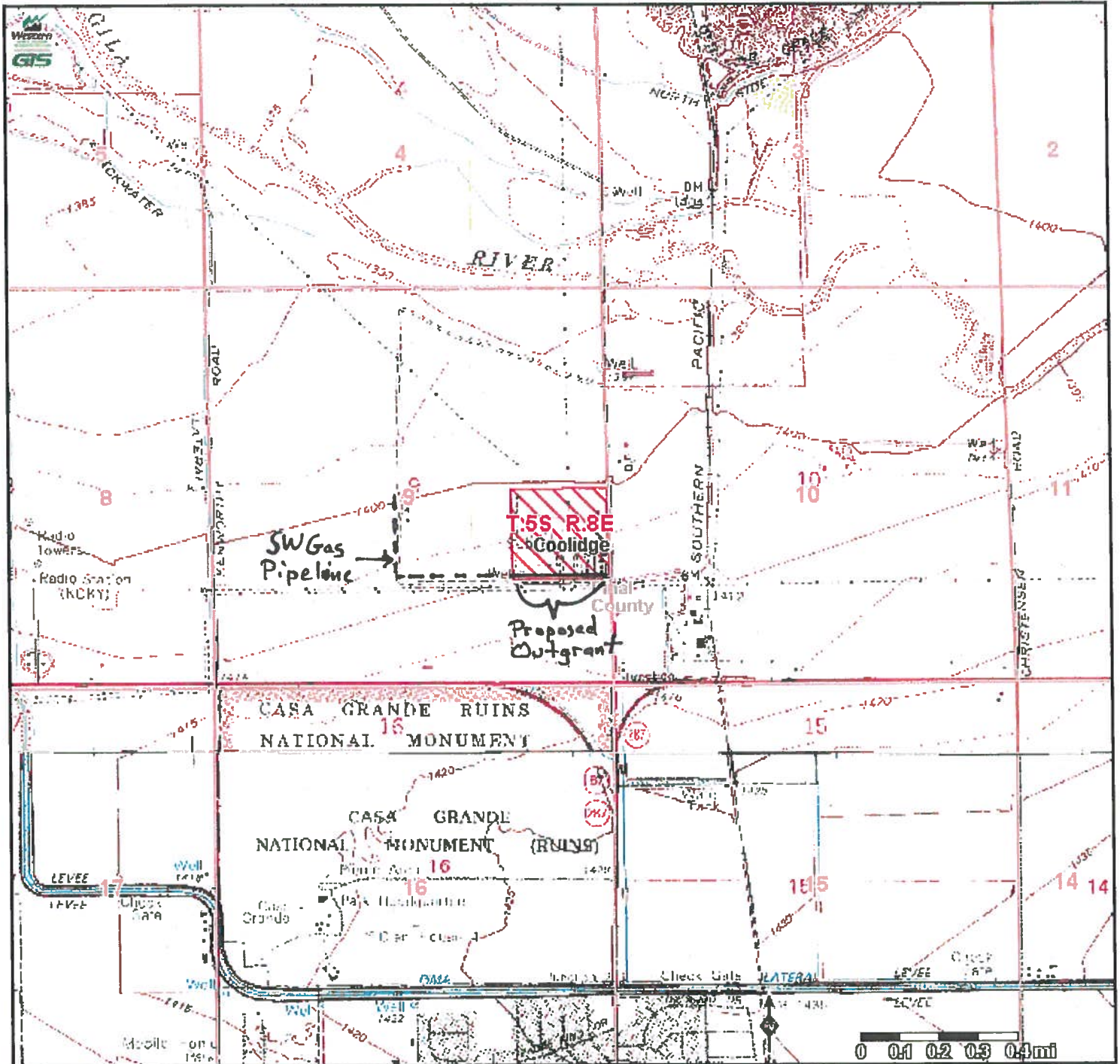

NEPA Compliance Officer: *Loid Marcant*

Date Determined: 2.18.14

# Desert Southwest Region



## Legend

-  Township & Range
-  Sections
-  Facility / Substation / Switchyard
-  Proposed Facilities
-  States
-  Counties
-  USGS 24K Topo-Quads

## Map Parameters

UTM ZONE 12, NAD83  
Scale 1:24,015

minx: 445681 maxx: 455987  
miny: 3649638 maxy: 3654953

2/14/2014 10:14 A.M.

Western Area Power Administration  
An agency of the U.S. Department of Energy



This map and data are the property of WAPA/DOE and are intended for planning and analysis only. ~~WAPA/DOE does not warrant the accuracy, completeness, or timeliness of the information provided on this map.~~ To contact WAPA about this map, please call 1-800-336-7288.

## **Categorical Exclusion Determination Form – Continuation Sheet**

Outgrant to Southwest Gas for an underground natural gas distribution pipeline at Coolidge Substation

### **Special Conditions:**

- 1) An archaeological monitor must be present during all, new ground disturbance on Western's property.
- 2) The applicant shall submit to Western a copy of any required air-quality or dust-control permit prior to construction.
- 3) The applicant shall submit to Western a copy of any required Storm water Pollution Prevention Plan and related notices prior to construction.

Checklist for Categorical Exclusion Determination, revised Nov. 2011

<b>Application of Categorical Exclusions (1021.410)</b>	<b>Disagree</b>	<b>Agree</b>	<b>Unknown</b>
(b)(1) The proposal fits within a class of actions that is listed in appendix A or B to subpart D.		X	
(b)(2) There are no extraordinary circumstances related to the proposal that may affect the significance of the environmental effects of the proposal, including, but not limited to, scientific controversy about the environmental effects of the proposal; uncertain effects or effects involving unique or unknown risks; and unresolved conflicts concerning alternate uses of available resources		X	
(b)(3) The proposal has not been segmented to meet the definition of a categorical exclusion. Segmentation can occur when a proposal is broken down into small parts in order to avoid the appearance of significance of the total action. The scope of a proposal must include the consideration of connected and cumulative actions, that is, the proposal is not connected to other actions with potentially significant impacts (40 CFR 1508.25(a)(1), is not related to other actions with individually insignificant but cumulatively significant impacts (40 CFR 1508.27(b)(7)), and is not precluded by 40 CFR 1506.1 or § 1021.211 of this part concerning limitations on actions during EIS preparation.		X	
<b>B. Conditions that are Integral Elements of the Classes of Actions in Appendix B. :</b>	<b>NO</b>	<b>YES</b>	<b>UNKNOWN</b>
(1) Threaten a violation of applicable statutory, regulatory, or permit requirements for environment, safety and health, or similar requirements of DOE or Executive Orders.	X		
(2) Require siting and construction or major expansion of waste storage, disposal, recovery, or treatment facilities (including incinerators), but the proposal may include categorically excluded waste storage, disposal, recovery, or treatment actions or facilities;	X		
(3) Disturb hazardous substances, pollutants, contaminants, or CERCLA-excluded petroleum and natural gas products that preexist in the environment such that there would be uncontrolled or unpermitted releases;	X		
(4) Have the potential to cause significant impacts on environmentally sensitive resources. An environmentally sensitive resource is typically a resource that has been identified as needing protection through Executive Order, statute, or regulation by Federal, state, or local government, or a federally recognized Indian tribe. An action may be categorically excluded if, although sensitive resources are present, the action would not have the potential to cause significant impacts on those resources (such as construction of a building with its foundation well above a sole-source aquifer or upland surface soil removal on a site that has wetlands). Environmentally sensitive resources include, but are not limited to:	X		
(ii) Property (such as sites, buildings, structures, and objects) of historic, archaeological, or architectural significance	X		

	designated by a Federal, state, or local government, or property determined to be eligible for listing on the National Register of Historic Places;			
(iii)	Federally-listed threatened or endangered species or their habitat (including critical habitat) or Federally- proposed or candidate species or their habitat (Endangered Species Act); state-listed or state-proposed endangered or threatened species or their habitat; Federally-protected marine mammals and Essential Fish Habitat (Marine Mammal Protection Act; Magnuson-Stevens Fishery Conservation and Management Act); and otherwise Federally-protected species (such as under the Bald and Golden Eagle Protection Act or the Migratory Bird Treaty Act);	X		
(iv)	Floodplains and wetlands (as defined in 10 CFR 1022.4, —Compliance with Floodplain and Wetland Environmental Review Requirements: “Definitions,” or its successor);	X		
(v)	Areas having a special designation such as Federally- and state-designated wilderness areas, national parks, national monuments, national natural landmarks, wild and scenic rivers, state and Federal wildlife refuges, scenic areas (such as National Scenic and Historic Trails or National Scenic Areas), and marine sanctuaries;	X		
(vi)	Prime or unique farmland, or other farmland of statewide or local importance, as defined at 7 CFR 658.2(a), —Farmland Protection Policy Act: Definitions,   or its successor;	X		
(vii)	Special sources of water (such as sole-source aquifers, wellhead protection areas, and other water sources that are vital in a region); and	X		
(viii)	Tundra, coral reefs, or rain forests.; or	X		
(5)	Involve genetically engineered organisms, synthetic biology, governmentally designated noxious weeds, or invasive species, unless the proposed activity would be contained or confined in a manner designed and operated to prevent unauthorized release into the environment and conducted in accordance with applicable requirements, such as those of the Department of Agriculture, the Environmental Protection Agency, and the National Institutes of Health.	X		

bcc.

Mr. Eddie Reyes

Southwest Gas

201 West Fourth Street, 32A-580

Casa Grande, Arizona 85122

G0400 (Marianito)

G0420 (Bilsbarrow)

CX file

G5607 (Herndon)

**FILE: 5440.04 COL**