



U.S. Department of Energy Categorical Exclusion Determination Form

Submit by E-mail

Proposed Action Title: Casa Grande Substation, CAG 262 Breaker Replacement

Program or Field Office: DOE/WESTERN/DESERT SOUTHWEST REGION

Location(s) (City/County/State): Casa Grande Substation, Casa Grande/ Pinal County/AZ

Proposed Action Description:

The project is located on Western-owned land in Township 6 South, Range 5 East, Section 24 in Casa Grande, Pinal County, Arizona. The Casa Grande substation is located southwest of the intersection of Thorton Road and Main Avenue.

Western Area Power Administration proposes to replace failed power circuit breaker CAG 262 with a similar power circuit breaker. New breaker will be of a higher voltage class and have a larger footprint. The new breaker will not require a new pad.

Existing electrical conduits will be used, but will need to be extended approximately three feet to the Southeast in order to enter the new breaker cabinet. The conduit will be approximately eighteen inches below the existing grade. Shovels will be used and the digging shall be conducted within existing disturbance for the conduit.

The project is located within the Lower Colorado river subdivision of the Sonoran Desert scrub biotic community. However the substation is located within disturbed and developed urban areas of Casa Grande. The fenced substation yard has been leveled and graveled; no native vegetation occurs within the substation.

Categorical Exclusion(s) Applied:

B1.3 - Routine maintenance

For the complete DOE National Environmental Policy Act regulations regarding categorical exclusions, including the full text of each categorical exclusion, see Subpart D of [10 CFR Part 1021](#).

Regulatory Requirements in 10 CFR 1021.410(b): (See full text in regulation)

The proposal fits within a class of actions that is listed in Appendix A or B to 10 CFR Part 1021, Subpart D.

To fit within the classes of actions listed in 10 CFR Part 1021, Subpart D, Appendix B, a proposal must be one that would not: (1) threaten a violation of applicable statutory, regulatory, or permit requirements for environment, safety, and health, or similar requirements of DOE or Executive Orders; (2) require siting and construction or major expansion of waste storage, disposal, recovery, or treatment facilities (including incinerators), but the proposal may include categorically excluded waste storage, disposal, recovery, or treatment actions or facilities; (3) disturb hazardous substances, pollutants, contaminants, or CERCLA-excluded petroleum and natural gas products that preexist in the environment such that there would be uncontrolled or unpermitted releases; (4) have the potential to cause significant impacts on environmentally sensitive resources, including, but not limited to, those listed in paragraph B(4) of 10 CFR Part 1021, Subpart D, Appendix B; (5) involve genetically engineered organisms, synthetic biology, governmentally designated noxious weeds, or invasive species, unless the proposed activity would be contained or confined in a manner designed and operated to prevent unauthorized release into the environment and conducted in accordance with applicable requirements, such as those listed in paragraph B(5) of 10 CFR Part 1021, Subpart D, Appendix B.

There are no extraordinary circumstances related to the proposal that may affect the significance of the environmental effects of the proposal.

The proposal has not been segmented to meet the definition of a categorical exclusion. This proposal is not connected to other actions with potentially significant impacts (40 CFR 1508.25(a)(1)), is not related to other actions with individually insignificant but cumulatively significant impacts (40 CFR 1508.27(b)(7)), and is not precluded by 40 CFR 1506.1 or 10 CFR 1021.211 concerning limitations on actions during preparation of an environmental impact statement.

Based on my review of the proposed action, as NEPA Compliance Officer (as authorized under DOE Order 451.1B), I have determined that the proposed action fits within the specified class(es) of action, the other regulatory requirements set forth above are met, and the proposed action is hereby categorically excluded from further NEPA review.

NEPA Compliance Officer:

John E. Marant

Date Determined:

84.4.13

Checklist for Categorical Exclusion Determination, revised Nov. 2011

Application of Categorical Exclusions (1021.410)	Disagree	Agree	Unknown
(b)(1) The proposal fits within a class of actions that is listed in appendix A or B to subpart D.		X	
(b)(2) There are no extraordinary circumstances related to the proposal that may affect the significance of the environmental effects of the proposal, including, but not limited to, scientific controversy about the environmental effects of the proposal; uncertain effects or effects involving unique or unknown risks; and unresolved conflicts concerning alternate uses of available resources		X	
(b)(3) The proposal has not been segmented to meet the definition of a categorical exclusion. Segmentation can occur when a proposal is broken down into small parts in order to avoid the appearance of significance of the total action. The scope of a proposal must include the consideration of connected and cumulative actions, that is, the proposal is not connected to other actions with potentially significant impacts (40 CFR 1508.25(a)(1), is not related to other actions with individually insignificant but cumulatively significant impacts (40 CFR 1508.27(b)(7)), and is not precluded by 40 CFR 1506.1 or § 1021.211 of this part concerning limitations on actions during EIS preparation.		X	
B. Conditions that are Integral Elements of the Classes of Actions in Appendix B. :	NO	YES	UNKNOWN
(1) Threaten a violation of applicable statutory, regulatory, or permit requirements for environment, safety and health, or similar requirements of DOE or Executive Orders.	X		
(2) Require siting and construction or major expansion of waste storage, disposal, recovery, or treatment facilities (including incinerators), but the proposal may include categorically excluded waste storage, disposal, recovery, or treatment actions or facilities;	X		
(3) Disturb hazardous substances, pollutants, contaminants, or CERCLA-excluded petroleum and natural gas products that preexist in the environment such that there would be uncontrolled or unpermitted releases;	X		
(4) Have the potential to cause significant impacts on environmentally sensitive resources. An environmentally sensitive resource is typically a resource that has been identified as needing protection through Executive Order, statute, or regulation by Federal, state, or local government, or a federally recognized Indian tribe. An action may be categorically excluded if, although sensitive resources are present, the action would not have the potential to cause significant impacts on those resources (such as construction of a building with its foundation well above a sole-source aquifer or upland surface soil removal on a site that has wetlands). Environmentally sensitive	X		

	resources include, but are not limited to:			
(i)	Property (such as sites, buildings, structures, and objects) of historic, archaeological, or architectural significance designated by a Federal, state, or local government, or property determined to be eligible for listing on the National Register of Historic Places;	X		
(ii)	Federally-listed threatened or endangered species or their habitat (including critical habitat) or Federally- proposed or candidate species or their habitat (Endangered Species Act); state-listed or state-proposed endangered or threatened species or their habitat; Federally-protected marine mammals and Essential Fish Habitat (Marine Mammal Protection Act; Magnuson-Stevens Fishery Conservation and Management Act); and otherwise Federally-protected species (such as under the Bald and Golden Eagle Protection Act or the Migratory Bird Treaty Act);	X		
(iii)	Floodplains and wetlands (as defined in 10 CFR 1022.4, — Compliance with Floodplain and Wetland Environmental Review Requirements: “Definitions,” or its successor);	X		
(iv)	Areas having a special designation such as Federally- and state-designated wilderness areas, national parks, national monuments, national natural landmarks, wild and scenic rivers, state and Federal wildlife refuges, scenic areas (such as National Scenic and Historic Trails or National Scenic Areas), and marine sanctuaries;	X		
(v)	Prime or unique farmland, or other farmland of statewide or local importance, as defined at 7 CFR 658.2(a), — Farmland Protection Policy Act: Definitions, or its successor;	X		
(vi)	Special sources of water (such as sole-source aquifers, wellhead protection areas, and other water sources that are vital in a region); and	X		
(vii)	Tundra, coral reefs, or rain forests.; or	X		
(5)	Involve genetically engineered organisms, synthetic biology, governmentally designated noxious weeds, or invasive species, unless the proposed activity would be contained or confined in a manner designed and operated to prevent unauthorized release into the environment and conducted in accordance with applicable requirements, such as those of the Department of Agriculture, the Environmental Protection Agency, and the National Institutes of Health.	X		

Biological Evaluation Short Form NEPA Supplement for ESA Compliance

NEPA Action: CE <input checked="" type="checkbox"/> EA <input type="checkbox"/> EIS <input type="checkbox"/>	Assigned Biologist: Johnida S. Dockens
Project Name: Casa Grande Substation Breaker Replacement (CAG 262)	NEPA Project Manager: Enoe Marcum
Project/WO #: 100247284	Western Project Manager: Steve Aiello/Grover Bray
Location Description (Land Ownership; Township, Range, Section (include Baseline and Meridian); County; State): The project is located on Western-owned land in Township 6 South, Range 5 East, Section 24 in Casa Grande, Pinal County, Arizona. The Casa Grande substation is located southwest of the intersection of Thorton Road and Main Avenue.	
Summary of Proposed Action & Purpose and Need for Proposed Action: Western proposes to replace breaker number 262 in the existing Casa Grande substation, located in Casa Grande, Arizona.	
Vegetation/Habitat Type: The project is located within the Lower Colorado River subdivision of the Sonoran Desertscrub biotic community. However the substation is located within a disturbed and developed urban areas of Casa Grande. The fenced substation yard has been leveled and graveled; no native vegetation occurs within the substation.	

I. Previous Biological Evaluation (BE)	No	Yes*
1. Prior Project BE: Name: _____ Completed By: _____ Date: _____	X	X
2. Update to BE or Surveys Required:		X
II. Species and/or Habitat	No	Yes
1. Site Visit Completed: _____ Date: 04/03/2013		X
2. Previous Species Observation (e.g., AGFD records, existing survey data):	X	
3. Species List(s) Obtained: _____ Date: 04/02/2013 (AGFD and USFWS online)		X
4. Habitat for Federally Listed Species Present (if Yes, include information in Notes)	X	
5. Federally Listed Species Present (if Yes, include information in Notes)	X	
6. Sensitive Species Present (Tribal or Federal Lands)	X	
7. Habitat for Sensitive Species Present (Tribal or Federal Lands)	X	
III. Analysis of Effects	No	Yes
1. Substantial Habitat Alteration	X	
2. Impacts Outside the Project Area	X	
3. Impacts to Native Vegetation	X	
4. Impacts to Riparian, Wetland and/or Water Resources	X	
IV. Determination of Effects (choose those that apply)		
1. No effect on listed species or habitat	<input checked="" type="checkbox"/>	
2. May affect, not likely to adversely affect listed species or habitat	<input type="checkbox"/>	
3. May affect, likely to adversely affect listed species or habitat	<input type="checkbox"/>	
4. No impact to individual sensitive species (Tribal/State)	<input checked="" type="checkbox"/>	
5. May impact individual sensitive species or sensitive species' population viability	<input type="checkbox"/>	
V. USFWS/Agency Consultation Requirements	No	Yes
1. Informal Consultation Required	X	
2. Formal Consultation Required	X	
3. Agency Review Required	X	
<i>*Refer to Additional Notes and Analysis section for details.</i>		

Mitigation Measures None
Attachments <ul style="list-style-type: none"> AGFD Online Environmental Tool Receipt (page 1 of 6)

Prepared By: Johnida S. Dockens NEPA Planner	Date: 04/03/2013
--	-------------------------

VI. Agency Concurrence (if applicable)			No	Yes
Concurrence Received:	FWS File Number:	Date:		
BO Received:		Date:		
Determination Rationale:				

Western's Routine Maintenance Programmatic Agreement Checklist

Date: 04/04/2013 Initials: JJ State: AZ CA Discovery: Yes No Emergency: Yes No

Project Name: Casa Grande Substation Breaker Replacement

Project Description: Western proposes to replace a failed power circuit breaker. The new breaker will be of a higher voltage class and have a larger footprint but will be within the existing developed yard.

Access: Existing roads, no road maintenance is required.

Project Type: (Write # Type) (PA Appendix B lists project categories)

- | | | | | |
|--|---|---|-----------------------------------|-------------------------------------|
| <input checked="" type="radio"/> I: No or Minor Ground Disturbance | <input checked="" type="checkbox"/> A: Substation | <input type="checkbox"/> B: T-line | <input type="checkbox"/> C: Comm | <input type="checkbox"/> D: General |
| <input type="radio"/> II: Minimal Ground Disturbance | <input type="checkbox"/> A: Substation | <input type="checkbox"/> B: T-line | <input type="checkbox"/> C: Comm | <input type="checkbox"/> D: General |
| <input type="radio"/> III: Extensive Ground Disturbance | <input type="checkbox"/> A: Substation | <input type="checkbox"/> B: T-line | <input type="checkbox"/> C: Comm | <input type="checkbox"/> D: General |
| <input type="radio"/> Building: | <input type="checkbox"/> Acquisition | <input type="checkbox"/> Rehabilitation | <input type="checkbox"/> Disposal | <input type="checkbox"/> Demolition |

Background Research Results: (surveyed, when, # & types of properties, condition)
[Required for Type II & III and building activities]

Western:

AZ CA SHPO:

Electronic Database:

Other:

Treatment Decision:

Type I Projects: no treatment needed [done] treatment conducted: Survey Monitor Field visit

Type II Projects: (45 years old or older)

<input type="checkbox"/> survey required	<input type="checkbox"/> properties present	<input type="checkbox"/> will be avoided [done]
<input type="checkbox"/> previously surveyed	<input type="checkbox"/> properties absent [done]	<input type="checkbox"/> cannot be avoided [consult w/SHPO & tribes]
<input type="checkbox"/> monitoring required	<input type="checkbox"/> properties present, but previously determined ineligible [done]	
<input type="checkbox"/> field visit required		
<input type="checkbox"/> no treatment required [done]	Why: _____	

Type III Projects: (45 years old or older)

<input type="checkbox"/> surveyed required	<input type="checkbox"/> properties present	<input type="checkbox"/> will be avoided [done]
<input type="checkbox"/> survey completed	<input type="checkbox"/> properties absent [done]	<input type="checkbox"/> cannot be avoided [consult w/SHPO & tribes]
<input type="checkbox"/> previously surveyed	<input type="checkbox"/> properties present, but previously determined ineligible [done]	

Building Projects:

<input type="checkbox"/> less than 45 years old, built _____ [done]	<input type="checkbox"/> 45 years old or older [consult w/SHPO & tribes]
<input type="checkbox"/> previously determined Not Eligible [done]	<input type="checkbox"/> determined Eligible [consult w/SHPO & tribes]
	<input type="checkbox"/> unknown eligibility [consult w/SHPO & tribes]

Documentation: [attach map showing project location]

Survey Report: properties present, send to SHPO & consulting parties on _____ [within 4 weeks of completion]
properties absent, to be included in Annual Report: AZ April 1, 2014

CA October 1,

Checklist: Project file copy SHPO PA file copy

Jill Jensen

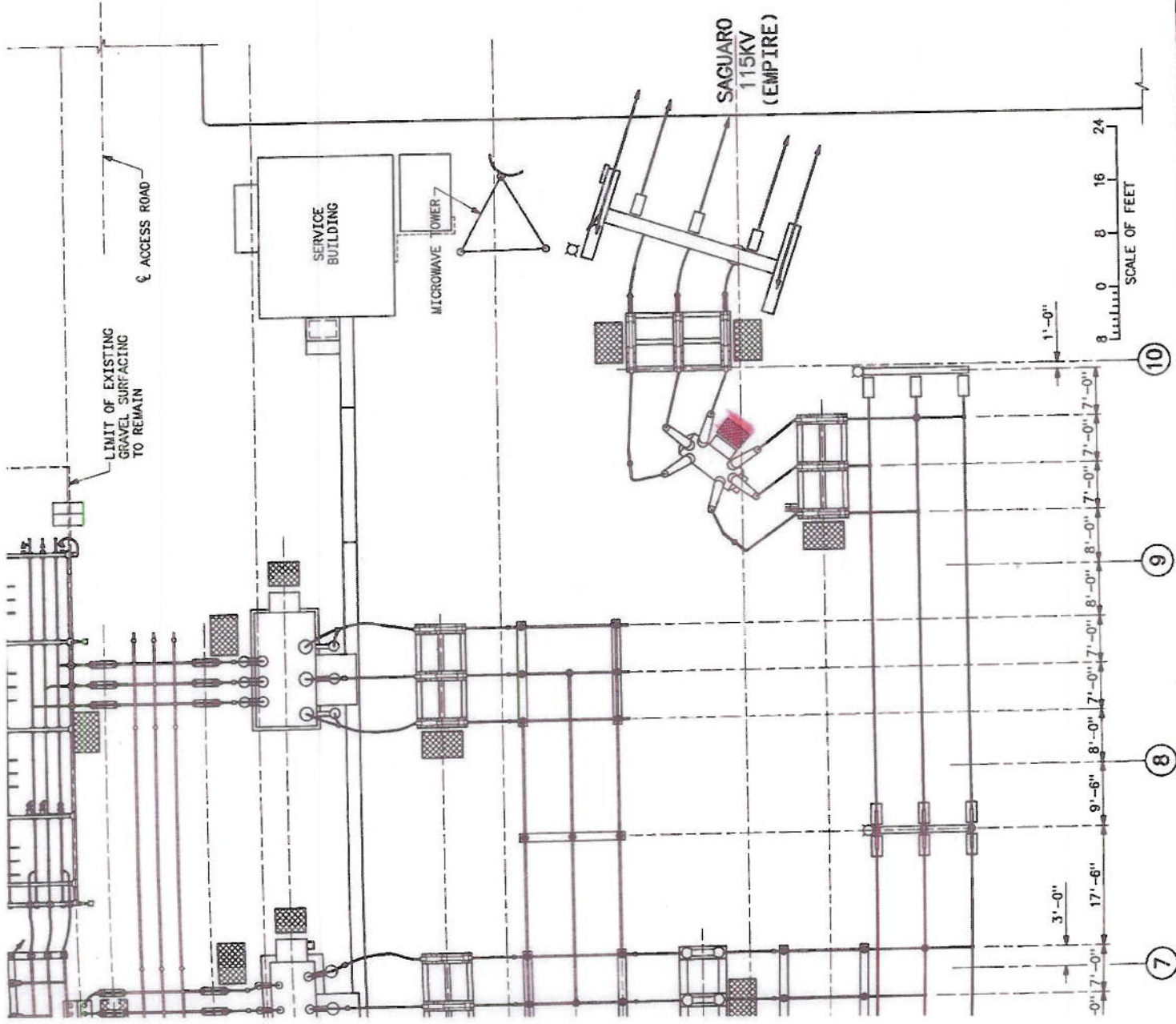

- REFERENCE DRAWINGS**
- SWITCHING DIAGRAM ----- CAG 0001
 - GENERAL PLOT PLAN ----- CAG 0010
 - 12.47KV BUS STRUCTURE "2" -----
 - PLAN AND SECTIONS ----- CAG 1010
 - CONDUIT, CABLE, & EQUIPMENT PLAN ----- CAG 1011
 - GROUNDING PLAN ----- CAG 1510
 - SERVICE BUILDING TYPE V-B ----- 31 3007
 - ARIZONA PUBLIC SERVICE DWG ----- D-9311
 - ARIZONA PUBLIC SERVICE DWG ----- G-9493

C	6-23-09	FIXED PHASE LABEL AND CONNECTION
B	9-1-05	STAGE 03 AS-BUILT
A	7-21-04	MINOR REVISIONS

SUPERSEDES DRAWING NO. CAG 1000

UNITED STATES DEPARTMENT OF ENERGY
WESTERN AREA POWER ADMINISTRATION
CORPORATE SERVICES OFFICE - LAKEWOOD, COLORADO

CASA GRANDE SUBSTATION
ARIZONA

GENERAL ARRANGEMENT

DESIGNED: SUSAN_BDF/JGLD ----- APPROVED: BOB CLARK
ELECTRICAL ENGINEERING MANAGER

MARCH 18, 2002 CAG 1000-1

REF (S) = CAG 9500

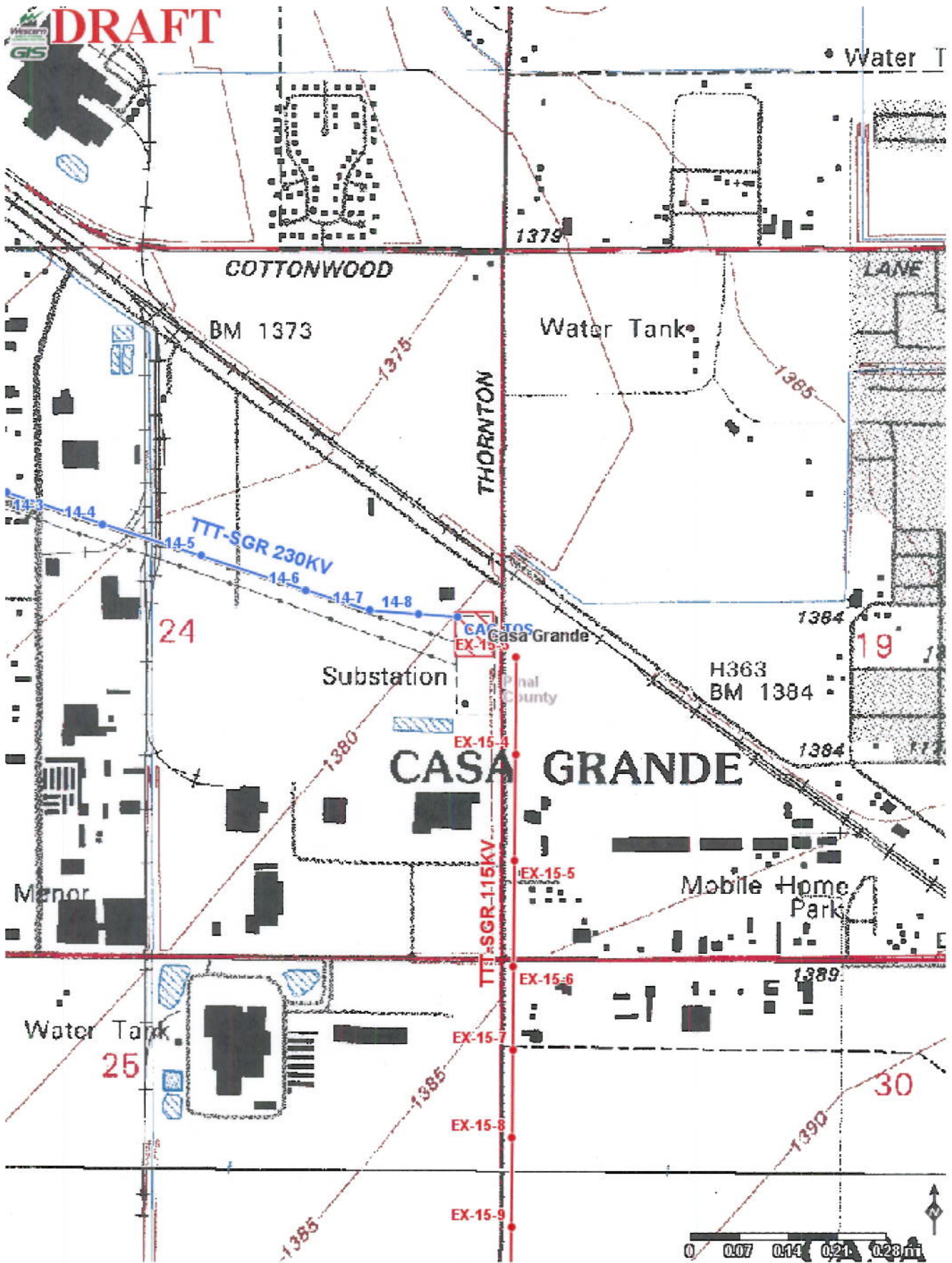

CAG Sub 

Control Bldg.

→ Breaker 262
is approximately
60' South of
Control Bldg.

© 2013 Google

N Thornton Rd

Imagery Date: 5/26/2012 32°53'09.50" N 111°46'28.65" W elev 1385 ft eye a

Google