

NEPA COMPLIANCE SURVEY #251

Project Information			
Project Title:	RMOTC process improvement Old pipe yard clean up.	Date:	11-03-09
DOE Code:		Contractor Code:	
Project Lead:	Terry Sullivan		
Project Overview 1. What are the environmental impacts? 2. What is the legal location? 3. What is the duration of the project? 4. What major equipment will be used if any (work over rig, drilling rig, etc.)?		We will dig out the pipe racks that are cemented into the ground, and haul them out. Then remove the weeds that have taken over the area. Then we will blade the location and have it ready if we ever decide to make farther improvements. I expect this to take aproximatly one week with two to three hands working on it. The impact to the environment should be minimal as this area has already been disturbed. The work will require the use of a backhoe and a blade as well as the cherry picker. This location is located just north of the shop. And has a 6 foot chain lind fence around it.	

The table below is to be completed by the Project Lead and reviewed by the Environmental Specialist and the DOE NEPA Compliance Officer. NOTE: If Change of Scope occurs, Project Lead must submit a new NEPA Compliance Survey and contact the Technical Assurance Department.

	Impacts Anticipated?			If YES, then complete below
	Yes	No	NA	If the anticipated impact might be unacceptable, recommend mitigation measures:
Water Quality				
Does the proposed project present potential for impacts on water resources or water quality?	<input type="checkbox"/>	<input checked="" type="checkbox"/>	<input type="checkbox"/>	
Does the project affect surface water quantity or quality under both normal operations and accident conditions?	<input type="checkbox"/>	<input checked="" type="checkbox"/>	<input type="checkbox"/>	
Does the proposed project affect groundwater quantity or quality under both normal operations and accident conditions?	<input type="checkbox"/>	<input checked="" type="checkbox"/>	<input type="checkbox"/>	
Will the project area include "Waters of the State?"	<input type="checkbox"/>	<input checked="" type="checkbox"/>	<input type="checkbox"/>	
Will the project area require a Corps of Engineers permit?	<input type="checkbox"/>	<input checked="" type="checkbox"/>	<input type="checkbox"/>	

NEPA COMPLIANCE SURVEY

	Impacts Anticipated?			If YES, then complete below.
	Yes	No	NA	If the anticipated impact might be unacceptable, recommend mitigation measures:
Geology & Soils				
Does the proposed project present potential for impacts related to geology or soils?	<input type="checkbox"/>	<input checked="" type="checkbox"/>	<input type="checkbox"/>	
Does the proposed project alter, excavate or otherwise disturb land area consistent with other land use and habitat area?	<input checked="" type="checkbox"/>	<input type="checkbox"/>	<input type="checkbox"/>	Best Management Practices should be followed to prevent disturbance of adjacent landfills. A haul road should be constructed to limit access t and disturbance o the location
Is the proposed project likely to impact local seismicity?	<input type="checkbox"/>	<input checked="" type="checkbox"/>	<input type="checkbox"/>	
If the project involved disturbance of surface soils, are erosion and storm water control measures addressed?	<input checked="" type="checkbox"/>	<input type="checkbox"/>	<input type="checkbox"/>	Best management Practices will be followed to prevent erosion of soils or disturbance to adjacent Landfarm Landfill. The area disturebed should be reseeded.
Air Quality				
Does the proposed action present potential for impacts on ambient air quality under both normal and accident conditions?	<input type="checkbox"/>	<input checked="" type="checkbox"/>	<input type="checkbox"/>	
Are potential emissions (gases and/or airborne particulates including dust) outside of the normal scope for oil field operations?	<input type="checkbox"/>	<input checked="" type="checkbox"/>	<input type="checkbox"/>	
Does the project present risk to human health and the environment from exposure to radiation and hazardous chemicals in emissions?	<input type="checkbox"/>	<input checked="" type="checkbox"/>	<input type="checkbox"/>	
Is the project subject to New Source Performance Standards?	<input type="checkbox"/>	<input checked="" type="checkbox"/>	<input type="checkbox"/>	
Is the project subject to National Emissions Standards for Hazardous Air Pollutants?	<input type="checkbox"/>	<input checked="" type="checkbox"/>	<input type="checkbox"/>	
Is the project subject to emissions limitations in an Air Quality Control Region?	<input type="checkbox"/>	<input checked="" type="checkbox"/>	<input type="checkbox"/>	

NEPA COMPLIANCE SURVEY

	Impacts Anticipated?			If YES, then complete below.
	Yes	No	NA	If the anticipated impact might be unacceptable, recommend mitigation measures:
Wildlife and Habitat				
Does the proposed action present potential for impacts on wildlife or habitat?	<input type="checkbox"/>	<input checked="" type="checkbox"/>	<input type="checkbox"/>	
Does the project impact state or federally listed threatened and endangered species?	<input type="checkbox"/>	<input checked="" type="checkbox"/>	<input type="checkbox"/>	
Human Health Effects				
Does the proposed project present potential for effects on human health? e.g.: Hanta virus, radiological exposure, or chemical exposure (must provide MSDS)	<input type="checkbox"/>	<input checked="" type="checkbox"/>	<input type="checkbox"/>	
Transportation				
Does the proposed project involve transportation of radiological sources or hazardous materials (including explosives)?	<input type="checkbox"/>	<input checked="" type="checkbox"/>	<input type="checkbox"/>	
Waste Management and Waste Minimization				
Are pollution prevention and waste minimization practices needed in the proposed project?	<input checked="" type="checkbox"/>	<input type="checkbox"/>	<input type="checkbox"/>	Best Management Practices will be followed to prevent erosion. Best Management will include control of equipment to adjacent areas. haul road to the area should be constructed
Does project plan establish procedures in compliance with local, state and/or federal laws and guidelines affecting the generation, transportation, treatment, storage or disposal of hazardous and other wastes?	<input checked="" type="checkbox"/>	<input type="checkbox"/>	<input type="checkbox"/>	A JSA shall be conducted each day before work is started. SOPs should be reviewed for compliance with State and local regulations.
Cultural Impact				
Is there potential for impact on cultural (historic) resources?	<input checked="" type="checkbox"/>	<input checked="" type="checkbox"/>	<input type="checkbox"/>	This area was reviewed by an Archeologist

m97
4/16/09

NEPA COMPLIANCE SURVEY

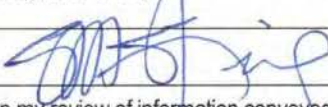
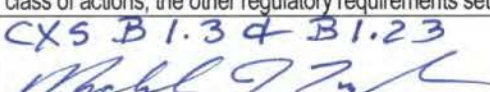
		Impacts Anticipated?			If YES, then complete below.
Community Impact		Yes	No	NA	If the anticipated impact might be unacceptable, recommend mitigation measures:
Will the proposed project introduce significantly adverse auditory, visual, or other impact?		<input type="checkbox"/>	<input checked="" type="checkbox"/>	<input type="checkbox"/>	
Will the proposed project adversely affect the community's use of public land/resources?		<input type="checkbox"/>	<input checked="" type="checkbox"/>	<input type="checkbox"/>	
Will the proposed project adversely affect the community's access to private land?		<input type="checkbox"/>	<input checked="" type="checkbox"/>	<input type="checkbox"/>	
NOTE: Topography Map and Wetlands Map are required to be attached. Attach applicable SOPs for Risk Assessment Level 2 & 3 and specific test procedures.					
Are permits required? If YES, list below:				Yes <input type="checkbox"/>	No <input checked="" type="checkbox"/>
Trenching/ confined space					
Section below to be reviewed by Environmental Specialist and DOE NCO.					
Adequate Mitigation Measures Provided?			Adequate Mitigation Measures Provided?		
	Yes	No		Yes	No
Water Quality Impacts	<input checked="" type="checkbox"/>	<input type="checkbox"/>	Transportation Impacts	<input checked="" type="checkbox"/>	<input type="checkbox"/>
Air Quality Impacts	<input checked="" type="checkbox"/>	<input type="checkbox"/>	Waste Management Impacts	<input checked="" type="checkbox"/>	<input type="checkbox"/>
"Wildlife and Habitat Impacts	<input checked="" type="checkbox"/>	<input type="checkbox"/>	Cultural Impacts	<input checked="" type="checkbox"/>	<input type="checkbox"/>
Geology and Soils Impacts	<input checked="" type="checkbox"/>	<input type="checkbox"/>	Community Impact	<input checked="" type="checkbox"/>	<input type="checkbox"/>
Human Health Impacts	<input checked="" type="checkbox"/>	<input type="checkbox"/>	Categorical Exclusion	<input checked="" type="checkbox"/>	<input type="checkbox"/>
Approvals					
Comments and Conditions:	<p>B1.3 Routine maintenance activities and custodial services for buildings, structures, rights-of-way, infrastructures (e.g., pathways, roads, and railroads), vehicles and equipment, and localized vegetation and pest control, during which operations may be suspended and resumed.</p> <p>Custodial services are activities to preserve facility appearance, working conditions, and sanitation, such as cleaning, window washing, lawn mowing, trash collection, painting, and snow removal. Routine maintenance activities, corrective (that is, repair), preventive, and predictive, are required to maintain and preserve buildings, structures, infrastructures, and equipment in a condition suitable for a facility to be used for its designated purpose. Routine maintenance may result in replacement to the extent that replacement is in kind and is not a substantial upgrade or improvement. In kind replacement includes installation of new components to replace outmoded components if the replacement does not result in a significant change in the expected useful life, design capacity, or function of the facility. Routine maintenance does not include replacement of a major component that significantly extends the originally intended useful life of a facility. Routine maintenance activities include, but are not limited to (h) Repair of road embankments; (j) Road and parking area resurfacing, including construction of temporary access to facilitate resurfacing;</p> <p>(k) Erosion control and soil stabilization measures (such as reseeding and revegetation);</p> <p>B1.23 Demolition and subsequent disposal of buildings, equipment, and support structures (including, but not limited to, smoke stacks and parking lot surfaces)</p>				
Contractor ESS&H	S. Shire 			Date: 11-14-09	
Comments and Conditions:	Based on my review of information conveyed to me and in my possession (or attached) concerning the proposed action, as NEPA Compliance Officer (as authorized under DOE Order 451.1A), I have determined that the proposed action fits within the specified class of actions, the other regulatory requirements set forth above are met, and the proposed action is hereby categorically excluded				
DOE NEPA Compliance Officer	CX5 B1.3 & B1.23 			Date 11/16/09	

32 33
5 4

5 4
8 9

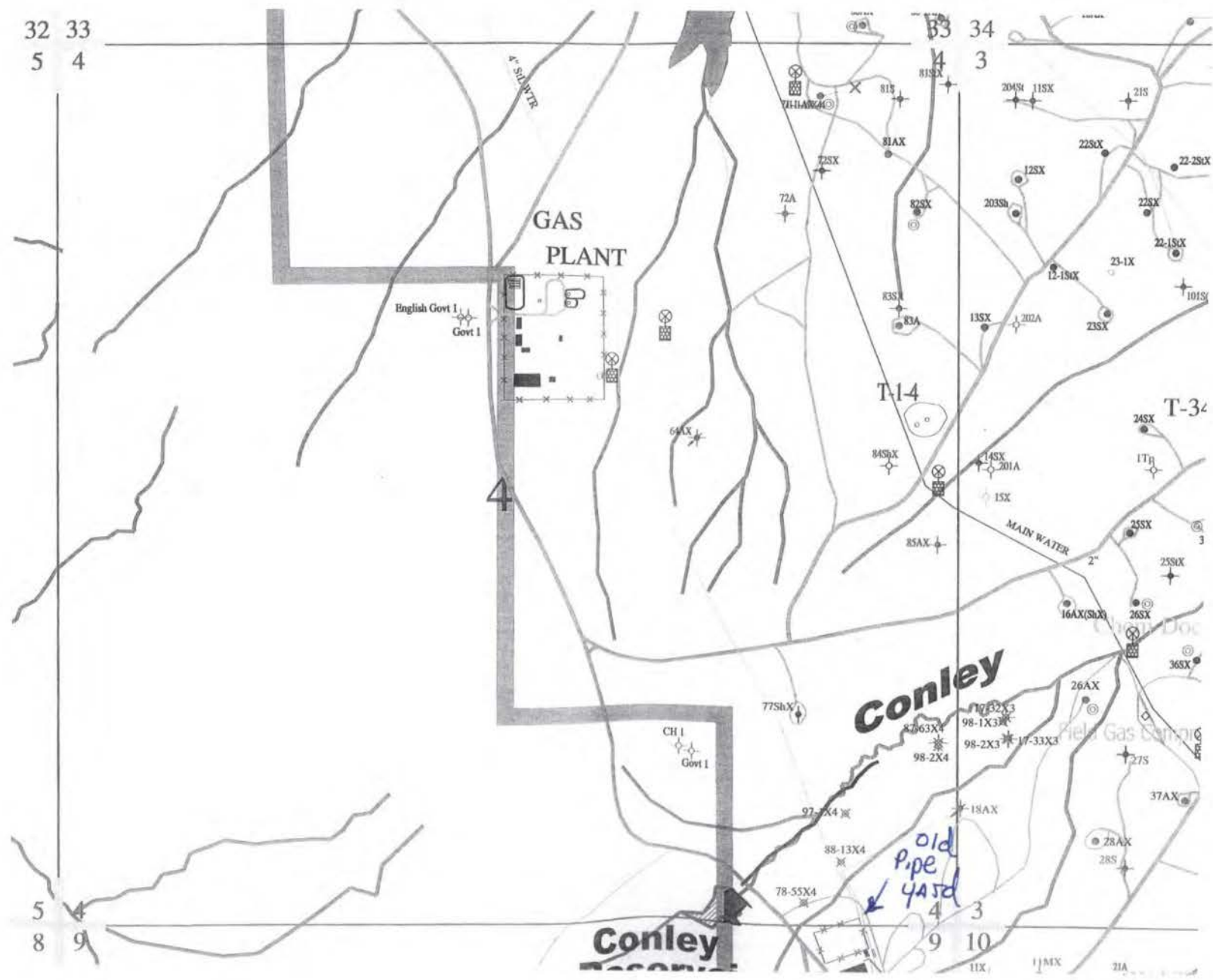

Conley

Conley

old pipe yard

FIELD DOC