

NEPA COMPLIANCE SURVEY

248

Project Information			
Project Title:	B-1-28 Test site reclamation.	Date:	11-12-09
DOE Code:		Contractor Code:	
Project Lead:	Rick McLaughlin		
Project Overview 1. What are the environmental impacts? 2. What is the legal location? 3. What is the duration of the project? 4. What major equipment will be used if any (work over rig, drilling rig, etc.)?		We will Dig up and cap or remove all the old shipping lines that are present. Then backfill and clean up the immediate area around the old test site. When it is all cleaned up we will seed the location. No building will be moved. Impact to the environment should be very slight, as all lines present are not in use. Any oil that might be present will be vac trucked out of the pipes. The site is located at N43 19.182 W196 13.158. The total time of this project should take apx. 4 days to complete. And will require the use of a backhoe, Dump truck, Vac truck, farm tractor, and welding truck.	

The table below is to be completed by the Project Lead and reviewed by the Environmental Specialist and the DOE NEPA Compliance Officer. NOTE: If Change of Scope occurs, Project Lead must submit a new NEPA Compliance Survey and contact the Technical Assurance Department.

	Impacts Anticipated?			If YES, then complete below
	Yes	No	NA	If the anticipated impact might be unacceptable, recommend mitigation measures:
Water Quality				
Does the proposed project present potential for impacts on water resources or water quality?	<input type="checkbox"/>	<input checked="" type="checkbox"/>	<input type="checkbox"/>	
Does the project affect surface water quantity or quality under both normal operations and accident conditions?	<input type="checkbox"/>	<input checked="" type="checkbox"/>	<input type="checkbox"/>	
Does the proposed project effect groundwater quantity or quality under both normal operations and accident conditions?	<input type="checkbox"/>	<input checked="" type="checkbox"/>	<input type="checkbox"/>	
Will the project area include "Waters of the State?"	<input type="checkbox"/>	<input checked="" type="checkbox"/>	<input type="checkbox"/>	
Will the project area require a Corps of Engineers permit?	<input type="checkbox"/>	<input checked="" type="checkbox"/>	<input type="checkbox"/>	

NEPA COMPLIANCE SURVEY

	Impacts Anticipated?			If YES, then complete below.
	Yes	No	NA	If the anticipated impact might be unacceptable, recommend mitigation measures:
Geology & Soils				
Does the proposed project present potential for impacts related to geology or soils?	<input type="checkbox"/>	<input checked="" type="checkbox"/>	<input type="checkbox"/>	
Does the proposed project alter, excavate or otherwise disturb land area consistent with other land use and habitat area?	<input type="checkbox"/>	<input checked="" type="checkbox"/>	<input type="checkbox"/>	
Is the proposed project likely to impact local seismicity?	<input type="checkbox"/>	<input checked="" type="checkbox"/>	<input type="checkbox"/>	
If the project involved disturbance of surface soils, are erosion and storm water control measures addressed?	<input type="checkbox"/>	<input checked="" type="checkbox"/>	<input type="checkbox"/>	Best Management Practices will be followed to prevent erosion of silt and soils. Dump truck will be used to move contaminated soil and provide clean soils for replacement
Air Quality				
Does the proposed action present potential for impacts on ambient air quality under both normal and accident conditions?	<input type="checkbox"/>	<input checked="" type="checkbox"/>	<input type="checkbox"/>	
Are potential emissions (gases and/or airborne particulates including dust) outside of the normal scope for oil field operations?	<input type="checkbox"/>	<input checked="" type="checkbox"/>	<input type="checkbox"/>	
Does the project present risk to human health and the environment from exposure to radiation and hazardous chemicals in emissions?	<input type="checkbox"/>	<input checked="" type="checkbox"/>	<input type="checkbox"/>	
Is the project subject to New Source Performance Standards?	<input type="checkbox"/>	<input checked="" type="checkbox"/>	<input type="checkbox"/>	
Is the project subject to National Emissions Standards for Hazardous Air Pollutants?	<input type="checkbox"/>	<input checked="" type="checkbox"/>	<input type="checkbox"/>	
Is the project subject to emissions limitations in an Air Quality Control Region?	<input type="checkbox"/>	<input checked="" type="checkbox"/>	<input type="checkbox"/>	

NEPA COMPLIANCE SURVEY

	Impacts Anticipated?			If YES, then complete below.
Wildlife and Habitat	Yes	No	NA	If the anticipated impact might be unacceptable, recommend mitigation measures:
Does the proposed action present potential for impacts on wildlife or habitat?	<input type="checkbox"/>	<input checked="" type="checkbox"/>	<input type="checkbox"/>	
Does the project impact state or federally listed threatened and endangered species?	<input type="checkbox"/>	<input checked="" type="checkbox"/>	<input type="checkbox"/>	
Human Health Effects	Yes	No	NA	If the anticipated impact might be unacceptable, recommend mitigation measures:
Does the proposed project present potential for effects on human health? e.g.: Hanta virus, radiological exposure, or chemical exposure (must provide MSDS)	<input type="checkbox"/>	<input checked="" type="checkbox"/>	<input type="checkbox"/>	
Transportation	Yes	No	NA	If the anticipated impact might be unacceptable, recommend mitigation measures:
Does the proposed project involve transportation of radiological sources or hazardous materials (including explosives)?	<input type="checkbox"/>	<input checked="" type="checkbox"/>	<input type="checkbox"/>	
Waste Management and Waste Minimization	Yes	No	NA	If the anticipated impact might be unacceptable, recommend mitigation measures:
Are pollution prevention and waste minimization practices needed in the proposed project?	<input checked="" type="checkbox"/>	<input type="checkbox"/>	<input type="checkbox"/>	Best Management Practices will be followed to prevent erosion. Reclamation equipment will be restricted to the adjacent area around the project.
Does project plan establish procedures in compliance with local, state and/or federal laws and guidelines affecting the generation, transportation, treatment, storage or disposal of hazardous and other wastes?	<input type="checkbox"/>	<input checked="" type="checkbox"/>	<input type="checkbox"/>	A JSA will be performed daily before work begins. SOPs will be reviewed for compliance to State and local regulation. Contaminated soils will be placed in the land farm and clean soils used for replacement. The area will be reseeded.
	Impacts Anticipated?			If YES, then complete below.
Cultural Impact	Yes	No	NA	If the anticipated impact might be unacceptable, recommend mitigation measures:
Is there potential for impact on cultural (historic) resources?	<input checked="" type="checkbox"/>	<input type="checkbox"/>	<input type="checkbox"/>	This area needs to be reviewed by an Archeologist before work is started.

NEPA COMPLIANCE SURVEY

Community Impact	Yes	No	NA	If the anticipated impact might be unacceptable, recommend mitigation measures:
Will the proposed project introduce significantly adverse auditory, visual, or other impact?	<input type="checkbox"/>	<input checked="" type="checkbox"/>	<input type="checkbox"/>	
Will the proposed project adversely affect the community's use of public land/resources?	<input type="checkbox"/>	<input checked="" type="checkbox"/>	<input type="checkbox"/>	
Will the proposed project adversely affect the community's access to private land?	<input type="checkbox"/>	<input checked="" type="checkbox"/>	<input type="checkbox"/>	

NOTE: Topography Map and Wetlands Map are required to be attached. Attach applicable SOPs for Risk Assessment Level 2 & 3 and specific test procedures.

Are permits required? If YES, list below:	Yes <input type="checkbox"/>	No <input checked="" type="checkbox"/>
---	------------------------------	--

Section below to be reviewed by Environmental Specialist and DOE NCO.

Adequate Mitigation Measures Provided?			Adequate Mitigation Measures Provided?		
	Yes	No		Yes	No
Water Quality Impacts	<input checked="" type="checkbox"/>	<input type="checkbox"/>	Transportation Impacts	<input checked="" type="checkbox"/>	<input type="checkbox"/>
Air Quality Impacts	<input checked="" type="checkbox"/>	<input type="checkbox"/>	Waste Management Impacts	<input checked="" type="checkbox"/>	<input type="checkbox"/>
*Wildlife and Habitat Impacts	<input checked="" type="checkbox"/>	<input type="checkbox"/>	Cultural Impacts	<input checked="" type="checkbox"/>	<input type="checkbox"/>
Geology and Soils Impacts	<input checked="" type="checkbox"/>	<input type="checkbox"/>	Community Impact	<input checked="" type="checkbox"/>	<input type="checkbox"/>
Human Health Impacts	<input checked="" type="checkbox"/>	<input type="checkbox"/>	Categorical Exclusion	<input checked="" type="checkbox"/>	<input type="checkbox"/>

Approvals

Comments and Conditions:	<p>B1.28 <u>Minor activities that are required to place a facility in an environmentally safe condition</u> where there is no proposed use for the facility. These activities would include, but are not limited to, reducing surface contamination, and removing materials, equipment or waste, such as final defueling of a reactor, where there are adequate existing facilities for the treatment, storage, or disposal of the materials, equipment or waste.</p> <p>B6.1 <u>Small-scale, short-term cleanup actions, under RCRA, Atomic Energy Act, or other authorities, less than approximately 5 million dollars in cost and 5 years duration, to reduce risk to human health or the environment from the release or threat of release of a hazardous substance other than high-level radioactive waste and spent nuclear fuel, including treatment (e.g., incineration), recovery, storage, or disposal of wastes at existing facilities currently handling the type of waste involved in the action.</u> These actions include, but are not limited to:</p> <p>(a) Excavation or consolidation of contaminated soils or materials from drainage channels, retention basins, ponds, and spill areas that are not receiving contaminated surface water or wastewater, if surface water or groundwater would not collect and if such actions would reduce the spread of, or direct contact with, the contamination;</p> <p>(b) Removal of bulk containers (for example, drums, barrels) that contain or may contain hazardous substances, pollutants, contaminants, CERCLA-excluded petroleum or natural gas products, or hazardous wastes (designated in 40 CFR part 261 or applicable state requirements), if such actions would reduce the likelihood of spillage, leakage, fire, explosion, or exposure to humans, animals, or the food chain; (c) Removal of an underground storage tank including its associated piping and underlying containment systems in compliance with RCRA, subtitle I; 40 CFR part 265, subpart J; and 40 CFR part 280, subparts F and G if such action would reduce the likelihood of spillage, leakage, or the spread of, or direct contact with, contamination; (d) Repair or replacement of leaking containers;</p> <p>(e) Capping or other containment of contaminated soils or sludges if the capping or containment would not affect future groundwater remediation and if needed to reduce migration of hazardous substances, pollutants, contaminants, or CERCLA-excluded petroleum and natural gas products into soil, groundwater, surface water, or air; (f) Drainage or closing of man-made surface impoundments if needed to maintain the integrity of the structures;</p> <p>(g) Confinement or perimeter protection using dikes, trenches, ditches, diversions, or installing underground barriers, if needed to reduce the spread of, or direct contact with, the contamination; (h) Stabilization, but not expansion, of berms, dikes, impoundments, or caps if needed to maintain integrity of the structures;</p> <p>(i) Drainage controls (for example, run-off or run-on diversion) if needed to reduce offsite migration of hazardous substances, pollutants, contaminants, or CERCLA-excluded petroleum or natural gas products or to prevent precipitation or run-off from other sources from entering the release area from other areas;</p>		
---------------------------------	--	--	--

Contractor ESS&H	S. SHire	Date 11-12-09
-----------------------------	----------	----------------------

Comments and Conditions:	Based on my review of information conveyed to me and in my possession (or attached) concerning the proposed action, as NEPA Compliance Officer (as authorized under DOE Order 451.1A), I have determined that the proposed action fits within the specified class of actions, the other regulatory requirements set forth above are met, and the proposed action is hereby categorically excluded from further NEPA review.	
---------------------------------	---	--

DOE NEPA Compliance Officer	CX5 B1.28 & B6.1 & B1.3K. 	Date 11/16/09
------------------------------------	-------------------------------	----------------------



ARCHEOLOGICAL REVIEW REQUIRED BEFORE DIRTWORK STARTS

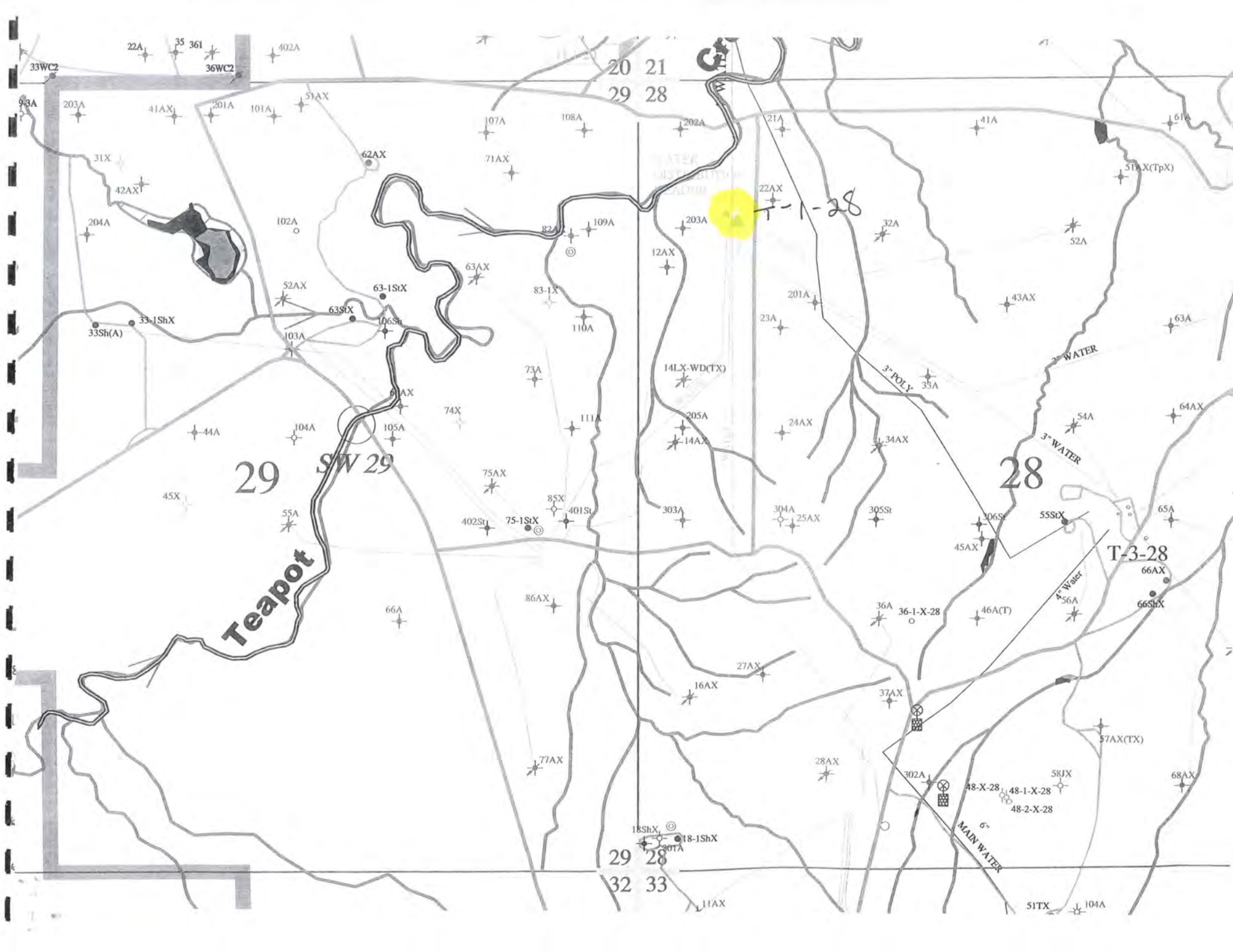

Teapot

29

SW 29

20 21
29 28

28

T-3-28

29 28
32 33



1-28

3" POLY

2" WATER

3" WATER

4" Water

6" MAIN WATER

18ShX
18-1ShX

48-X-28
48-1-X-28
48-2-X-28

11AX

51TX 104A