

NEPA COMPLIANCE SURVEY # 278

Project Information			
Project Title:	Change out down guy on power pole	Date:	2-8-10
DOE Code:		Contractor Code:	
Project Lead:	Mike Preston		
Project Overview			
1. What are the environmental impacts?	No impact to the environment.		
2. What is the legal location?	Power pole east of B-1-33		
3. What is the duration of the project?	3 Hr		
4. What major equipment will be used if any (work over rig, drilling rig, etc.)?	Backhoe and operator for equipment		

The table below is to be completed by the Project Lead and reviewed by the Environmental Specialist and the DOE NEPA Compliance Officer. NOTE: If Change of Scope occurs, Project Lead must submit a new NEPA Compliance Survey and contact the Technical Assurance Department.

	Impacts Anticipated?			If YES, then complete below
	Yes	No	NA	If the anticipated impact might be unacceptable, recommend mitigation measures:
Water Quality				
Does the proposed project present potential for impacts on water resources or water quality?	<input type="checkbox"/>	<input checked="" type="checkbox"/>	<input type="checkbox"/>	
Does the project affect surface water quantity or quality under both normal operations and accident conditions?	<input type="checkbox"/>	<input checked="" type="checkbox"/>	<input type="checkbox"/>	
Does the proposed project affect groundwater quantity or quality under both normal operations and accident conditions?	<input type="checkbox"/>	<input checked="" type="checkbox"/>	<input type="checkbox"/>	
Will the project area include "Waters of the State?"	<input type="checkbox"/>	<input checked="" type="checkbox"/>	<input type="checkbox"/>	
Will the project area require a Corps of Engineers permit?	<input type="checkbox"/>	<input checked="" type="checkbox"/>	<input type="checkbox"/>	

NEPA COMPLIANCE SURVEY

	Impacts Anticipated?			If YES, then complete below.
	Yes	No	NA	If the anticipated impact might be unacceptable, recommend mitigation measures:
Geology & Soils				
Does the proposed project present potential for impacts related to geology or soils?	<input type="checkbox"/>	<input checked="" type="checkbox"/>	<input type="checkbox"/>	Best Commercial Practices were used to prevent erosion.
Does the proposed project alter, excavate or otherwise disturb land area consistent with other land use and habitat area?	<input type="checkbox"/>	<input checked="" type="checkbox"/>	<input type="checkbox"/>	
Is the proposed project likely to impact local seismicity?	<input type="checkbox"/>	<input checked="" type="checkbox"/>	<input type="checkbox"/>	
If the project involved disturbance of surface soils, are erosion and storm water control measures addressed?	<input type="checkbox"/>	<input checked="" type="checkbox"/>	<input type="checkbox"/>	Best Management Practices will be used to prevent soil and silt erosion.
Air Quality				
Does the proposed action present potential for impacts on ambient air quality under both normal and accident conditions?	<input type="checkbox"/>	<input checked="" type="checkbox"/>	<input type="checkbox"/>	
Are potential emissions (gases and/or airborne particulates including dust) outside of the normal scope for oil field operations?	<input type="checkbox"/>	<input checked="" type="checkbox"/>	<input type="checkbox"/>	
Does the project present risk to human health and the environment from exposure to radiation and hazardous chemicals in emissions?	<input type="checkbox"/>	<input checked="" type="checkbox"/>	<input type="checkbox"/>	
Is the project subject to New Source Performance Standards?	<input type="checkbox"/>	<input checked="" type="checkbox"/>	<input type="checkbox"/>	
Is the project subject to National Emissions Standards for Hazardous Air Pollutants?	<input type="checkbox"/>	<input checked="" type="checkbox"/>	<input type="checkbox"/>	
Is the project subject to emissions limitations in an Air Quality Control Region?	<input type="checkbox"/>	<input checked="" type="checkbox"/>	<input type="checkbox"/>	

NEPA COMPLIANCE SURVEY

	Impacts Anticipated?			If YES, then complete below.
	Yes	No	NA	If the anticipated impact might be unacceptable, recommend mitigation measures:
Wildlife and Habitat				
Does the proposed action present potential for impacts on wildlife or habitat?	<input type="checkbox"/>	<input checked="" type="checkbox"/>	<input type="checkbox"/>	
Does the project impact state or federally listed threatened and endangered species?	<input type="checkbox"/>	<input checked="" type="checkbox"/>	<input type="checkbox"/>	
Human Health Effects				
Does the proposed project present potential for effects on human health? e.g.: Hanta virus, radiological exposure, or chemical exposure (must provide MSDS)	<input type="checkbox"/>	<input checked="" type="checkbox"/>	<input type="checkbox"/>	
Transportation				
Does the proposed project involve transportation of radiological sources or hazardous materials (including explosives)?	<input type="checkbox"/>	<input checked="" type="checkbox"/>	<input type="checkbox"/>	
Waste Management and Waste Minimization				
Are pollution prevention and waste minimization practices needed in the proposed project?	<input type="checkbox"/>	<input checked="" type="checkbox"/>	<input type="checkbox"/>	
Does project plan establish procedures in compliance with local, state and/or federal laws and guidelines affecting the generation, transportation, treatment, storage or disposal of hazardous and other wastes?	<input checked="" type="checkbox"/>	<input type="checkbox"/>	<input type="checkbox"/>	A JSA will be performed prior to beginning of the work. SOPs will be reviewed for compliance to state and local regulations.

NEPA COMPLIANCE SURVEY

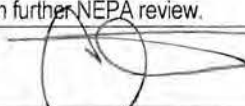
		Impacts Anticipated?			If YES, then complete below.
Cultural Impact		Yes	No	NA	If the anticipated impact might be unacceptable, recommend mitigation measures:
Is there potential for impact on cultural (historic) resources?		<input type="checkbox"/>	<input checked="" type="checkbox"/>	<input type="checkbox"/>	
Community Impact		Yes	No	NA	If the anticipated impact might be unacceptable, recommend mitigation measures:
Will the proposed project introduce significantly adverse auditory, visual, or other impact?		<input type="checkbox"/>	<input checked="" type="checkbox"/>	<input type="checkbox"/>	
Will the proposed project adversely affect the community's use of public land/resources?		<input type="checkbox"/>	<input checked="" type="checkbox"/>	<input type="checkbox"/>	
Will the proposed project adversely affect the community's access to private land?		<input type="checkbox"/>	<input checked="" type="checkbox"/>	<input type="checkbox"/>	
NOTE: Topography Map and Wetlands Map are required to be attached. Attach applicable SOPs for Risk Assessment Level 2 & 3 and specific test procedures.					
Are permits required? If YES, list below:				Yes <input type="checkbox"/>	No <input checked="" type="checkbox"/>
Section below to be reviewed by Environmental Specialist and DOE NCO.					
Adequate Mitigation Measures Provided?			Adequate Mitigation Measures Provided?		
	Yes	No		Yes	No
Water Quality Impacts	<input checked="" type="checkbox"/>	<input type="checkbox"/>	Transportation Impacts	<input checked="" type="checkbox"/>	<input type="checkbox"/>
Air Quality Impacts	<input checked="" type="checkbox"/>	<input type="checkbox"/>	Waste Management Impacts	<input checked="" type="checkbox"/>	<input type="checkbox"/>
Wildlife and Habitat Impacts	<input checked="" type="checkbox"/>	<input type="checkbox"/>	Cultural Impacts	<input checked="" type="checkbox"/>	<input type="checkbox"/>
Geology and Soils Impacts	<input checked="" type="checkbox"/>	<input type="checkbox"/>	Community Impact	<input checked="" type="checkbox"/>	<input type="checkbox"/>
Human Health Impacts	<input checked="" type="checkbox"/>	<input type="checkbox"/>	Categorical Exclusion	<input type="checkbox"/>	<input type="checkbox"/>
Approvals					
Comments and Conditions:	B1.3 Routine maintenance activities and custodial services for buildings, structures, rights-of-way, infrastructures (e.g., pathways, roads, and railroads), vehicles and equipment, and localized vegetation and pest control, during which operations may be suspended and resumed. Custodial services are activities to preserve facility appearance, working conditions, and sanitation, such as cleaning, window washing, lawn mowing, trash collection, painting, and snow removal. Routine maintenance activities, corrective (that is, repair), preventative, and predictive, are required to maintain and preserve buildings, structures, infrastructures, and equipment in a condition suitable for a facility to be used for its designated purpose. Routine maintenance may result in replacement to the extent that replacement is in kind and is not a substantial upgrade or improvement. In kind replacement includes installation of new components to replace outmoded components, if the replacement does not result in a significant change in the expected useful life, design capacity, or function of the facility. (e) Plumbing, electric utility, and telephone service repair.				
Contractor ESS&H	Teri North 			Date: 2/10/2010	
Comments and Conditions:	Based on my review of information conveyed to me and in my possession (or attached) concerning the proposed action, as NEPA Compliance Officer (as authorized under DOE Order 451.1A), I have determined that the proposed action fits within the specified class of actions, the other regulatory requirements set forth above are met, and the proposed action is hereby categorically excluded from further NEPA review.				
DOE NEPA Compliance Officer				Date: 2/11/10	

B-1-33





Down Guy - B-1-33



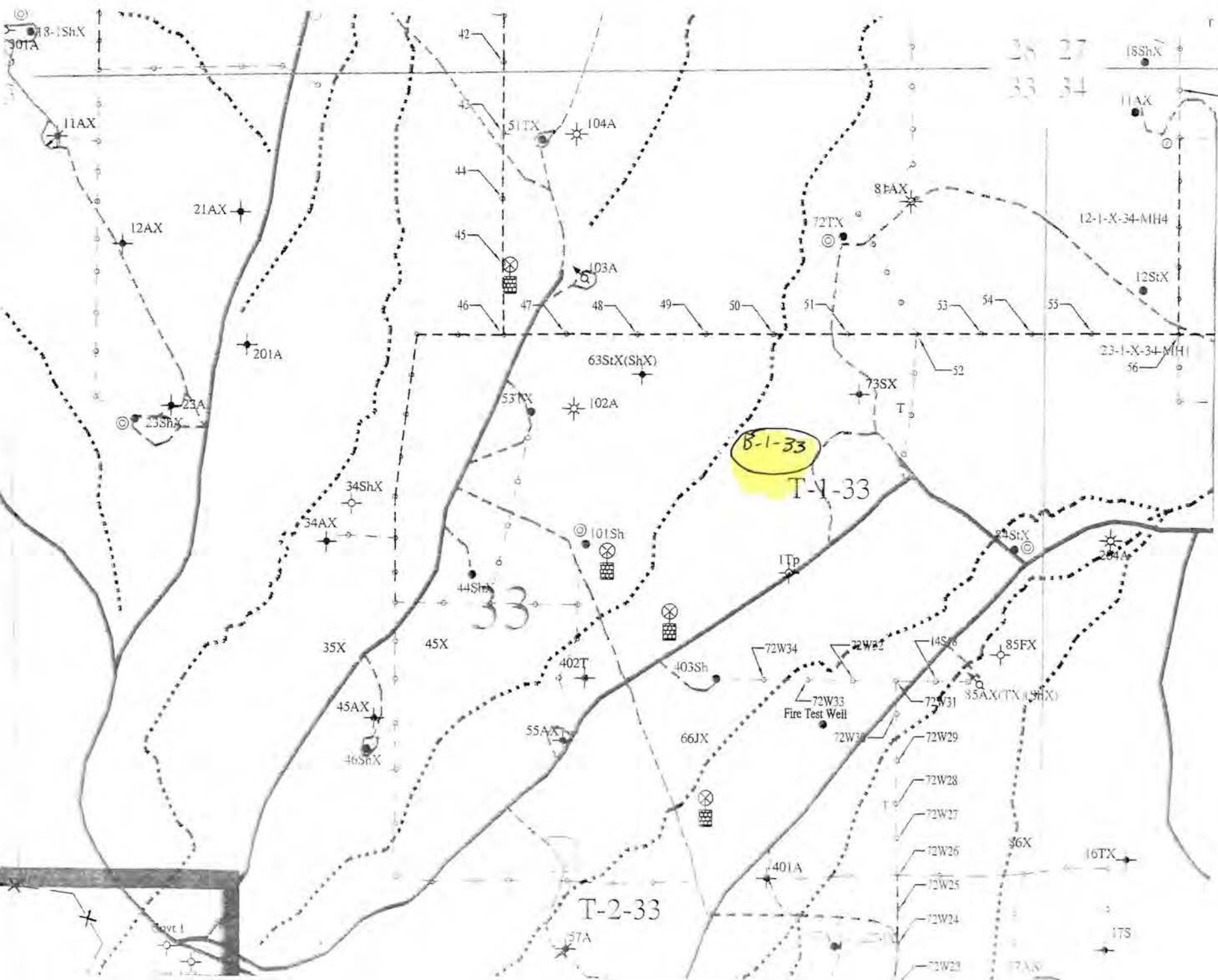

B-1-33

T-1-33

33

T-2-33

38 27
33 34

16TX
17S